











# More Precision

**confocalDT** // Confocal chromatic sensor system



# Light-intensive controller for high speed measurements

## confocalDT IFC246x

-  Measuring rate up to 30 kHz
-  **INTERFACE** Ethernet / EtherCAT / RS422 / PROFINET / Ethernet/IP / Analog
-  Fast surface compensation and high light intensity
-  Configuration via web interface
-  Submicron resolution
-  Thickness measurement of multi-layer materials
-  Synchronous two-sided thickness measurement
-  Robust design with passive cooling



The confocalDT 2465 and 2466 controllers enable fast, high-precision distance and thickness measurements up to 30 kHz. The controllers are available as a single- or dual-channel variant. Using a special calculation function, the confocalDT 2466 dual-channel version evaluates both channels. Measurement acquisition is synchronous and can be carried out while exploiting the full measuring rate for both channels.

Available as a standard version for distance and thickness measurements as well as a multi-peak version, the controllers are compatible with all sensor types of the IFS series. The multi-peak models are used for the thickness measurement of up to 5 transparent layers.

Due to a user-friendly web interface, no additional software is necessary to configure the controller and the sensors. Data output is via Ethernet, EtherCAT, RS422 or analog output. Optionally available interface modules enable the data to be output also via PROFINET or EtherNet/IP.

### High luminous intensity for challenging measuring objects

A controller version with high light intensity is available for measuring low-reflecting objects. Especially with tilted or dark surfaces, the enhanced light intensity increases the proportion of reflected light and enables stable measurements.



Settings are made via the web interface. For thickness measurements, materials are stored in an expandable materials database.

| Model                                     | IFC2465           |  | IFC2465MP   |  | IFC2466         | IFC2466MP |
|---|-------------------|--|---|--|-----------------|-----------|
|   | Ethernet/EtherCAT |  | 1 nm  |  |                 |           |
| Resolution                                | RS422             |  | 18 bit  |  |                 |           |
|   | Analog            |  | 16 bits (teachable)   |  |                 |           |
| Measuring rate                            |                   |  | continuously adjustable from 100 Hz to 30 kHz   |  |                 |           |
| Linearity                                 |                   |  | typ. < ±0.025 % FSO (depends on sensor)   |  |                 |           |
| Multi-peak measurement                    | 1 layer           |  | 5 layers  |  | 1 layer         | 5 layers  |
| Light source                              |                   |  | internal white LED; high-power LED for variant with double light intensity  |  |                 |           |
| No. of characteristic curves              |                   |  | up to 20 characteristic curves for different sensors per channel, selection via table in the menu   |  |                 |           |
| Permissible ambient light <sup>1)</sup>   |                   |  | 30,000 lx   |  |                 |           |
| Synchronization                           |                   |  | yes   |  |                 |           |
| Supply voltage                            |                   |  | 24 VDC ±15 %  |  |                 |           |
| Power consumption                         |                   |  | approx. 10 W; approx. 20 W with double light intensity option   |  |                 |           |
| Signal input                              |                   |  | sync-in / trig-in; 2x encoders (A+, A-, B+, B-, index) or 3x encoders (A+, A-, B+, B-)  |  |                 |           |
| Digital interface                         |                   |  | Ethernet / EtherCAT / RS422 / PROFINET <sup>2)</sup> / EtherNet/IP <sup>2)</sup>  |  |                 |           |
| Analog output                             |                   |  | Current: 4 ... 20 mA; voltage: 0 ... 10 V (16 bit D/A converter)  |  |                 |           |
| Switching output                          |                   |  | Error1-Out, Error2-Out  |  |                 |           |
| Digital output                            |                   |  | sync-out  |  |                 |           |
| Connection                                | Optical           |  | pluggable optical fiber via E2000 socket, length 2 m ... 50 m, min. bending radius 30 mm  |  |                 |           |
|   | Electrical        |  | 3-pin supply terminal strip; encoder connection (15-pin, HD-sub socket, max. cable length 3 m, 30 m with external encoder supply); RS422 connection socket (9-pin, Sub-D, max. cable length 30 m); 3-pin output terminal strip (max. cable length 30 m); 11-pin I/O terminal strip (max. cable length 30 m); RJ45 socket for Ethernet (out) / EtherCAT (in/out) (max. cable length 100 m) |  |                 |           |
| Installation                              |                   |  | Free-standing, DIN rail mounting  |  |                 |           |
| Temperature range                         | Storage           |  | -20 ... +70 °C  |  |                 |           |
|   | Operation         |  | +5 ... +50 °C   |  |                 |           |
| Shock (DIN EN 60068-2-27)                 |                   |  | 15g / 6 ms in XYZ axis, 1000 shocks each  |  |                 |           |
| Vibration (DIN EN 60068-2-6)              |                   |  | 2g / 20 ... 500 Hz in XYZ axis, 10 cycles each  |  |                 |           |
| Protection class (DIN EN 60529)           |                   |  | IP40  |  |                 |           |
| Material                                  |                   |  | Aluminum  |  |                 |           |
| Weight                                    |                   |  | approx. 1.8 kg  |  | approx. 2.25 kg |           |
| Compatibility                             |                   |  | compatible with all confocalDT sensors  |  |                 |           |
| No. of measurement channels <sup>3)</sup> |                   |  | 1   |  | 2               |           |
| Control and indicator elements            |                   |  | Multifunction button (two adjustable functions and reset to factory setting after 10 s); 5x LEDs for intensity, range, status and supply voltage  |  |                 |           |

FSO = Full Scale Output

<sup>1)</sup> Illuminant: light bulb

<sup>2)</sup> Connection via interface module (see accessories)

<sup>3)</sup> No loss of intensity and linearity due to two synchronous measurement channels

#### IFC2465 Controller

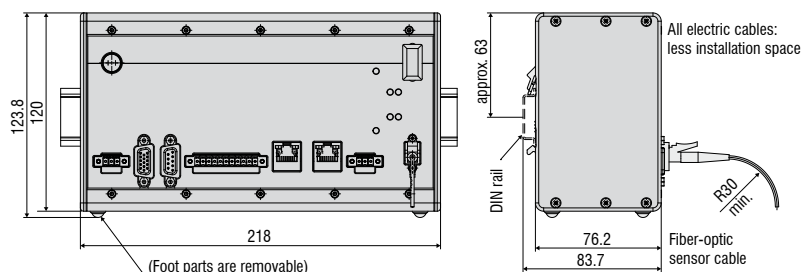

#### IFC2466 Controller

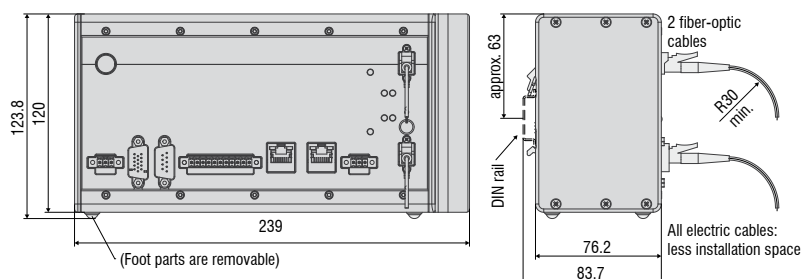

# System design

## confocalDT

### Cable concepts for every application

The connection options are diverse and can be adapted to your plant or machine concept.

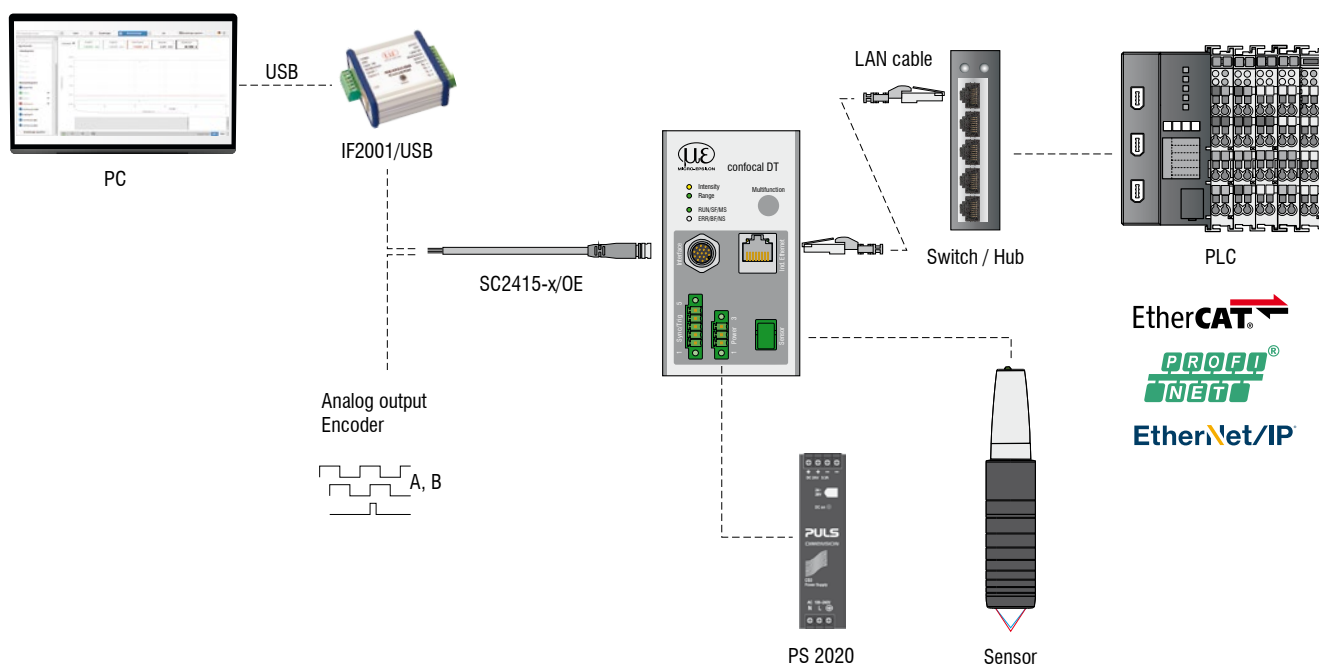
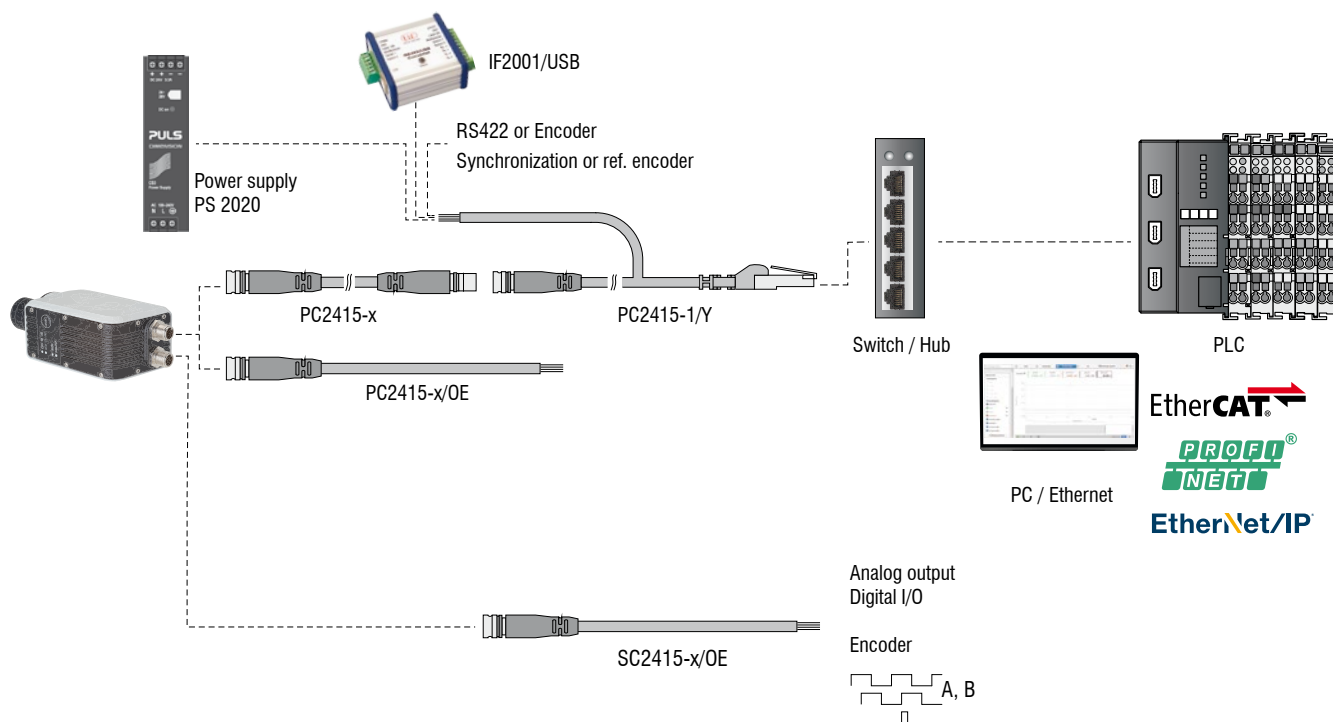

**The confocalDT system consists of:**

- Sensor IFS240x
- Controller IFC24xx
- Fiber optic cable C24xx

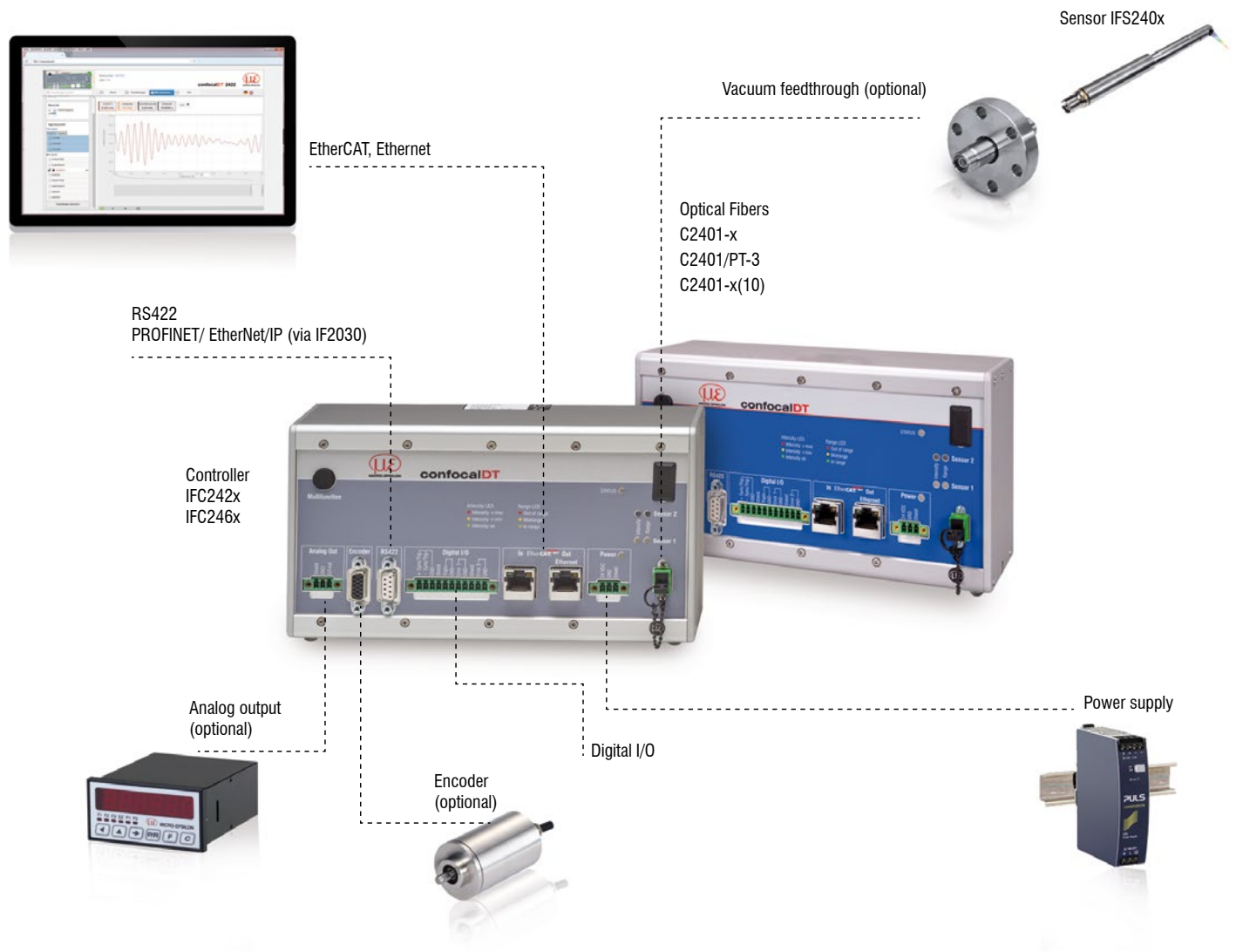

# Customer-specific modifications

## confocalDT

### Customer-specific modifications

Application examples are often found where the standard versions of the sensors and the controllers are performing at their limits. To facilitate such special tasks, it is possible to customize the sensor design and to adjust the controller accordingly. Common requests for modifications include changes in design, mounting options, customized cable lengths and modified measuring ranges.



### Possible modifications

- Sensors with connector
- Cable length
- Vacuum suitability up to UHV
- Specific lengths
- Customer-specific mounting options
- Optical filter for ambient light compensation
- Housing material
- Measuring range / Offset distance

### Vacuum setup

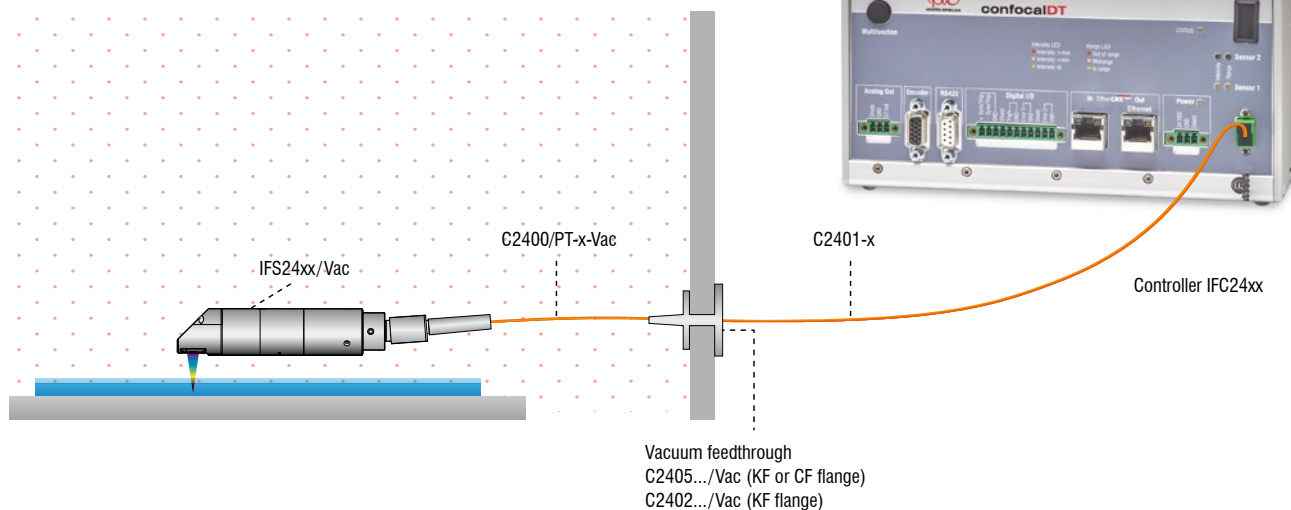

# Accessories

## Mounting adapter

**Accessories: mounting adapter**  
MA2402 for sensors 2402

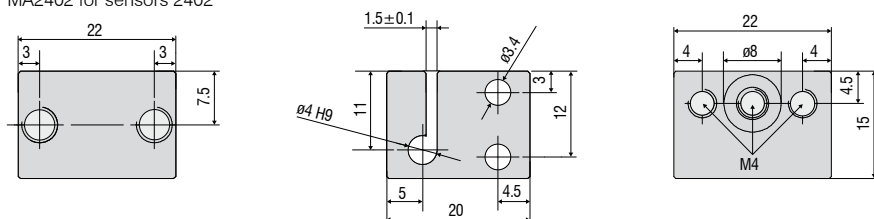

**Accessories: mounting adapter**  
MA2403 for sensors 2403

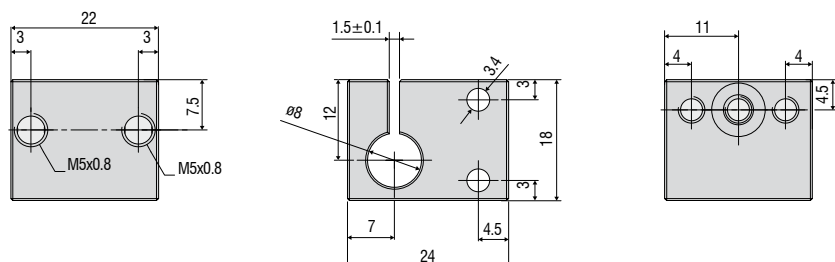

**Accessories: mounting adapter**  
MA2404-12 for sensors IFS2404-2 / IFS2404/90-2 / IFS2407-0,1

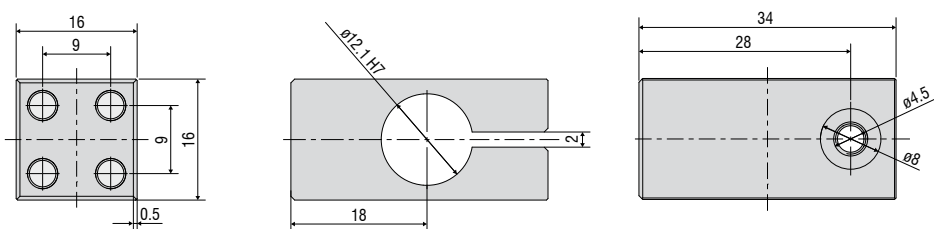

**Accessories: mounting adapter**  
MA2400 for sensors IFS2405 / IFS2406 / IFS2407 (consisting of a mounting block and a mounting ring)

Mounting block

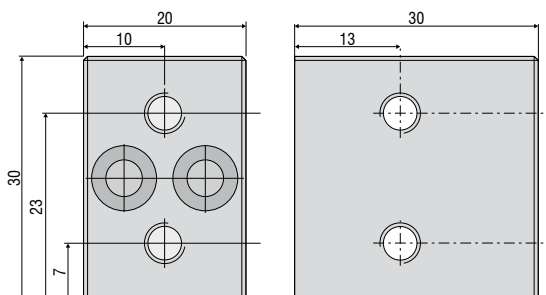

Mounting ring

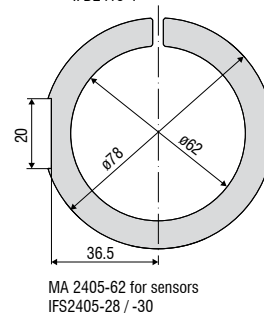
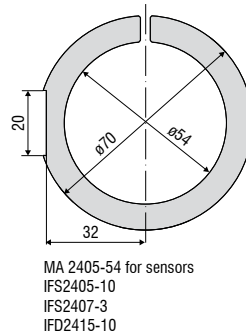
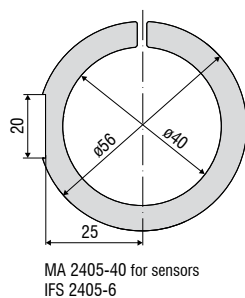
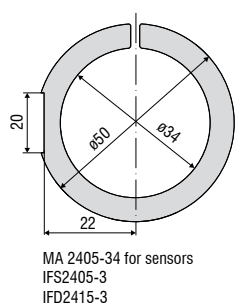
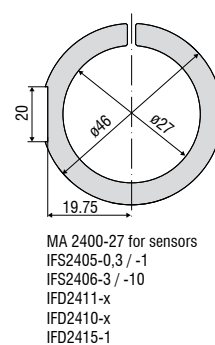
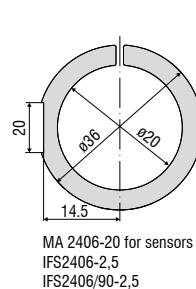

## Accessories

### Adjustable mounting adapters

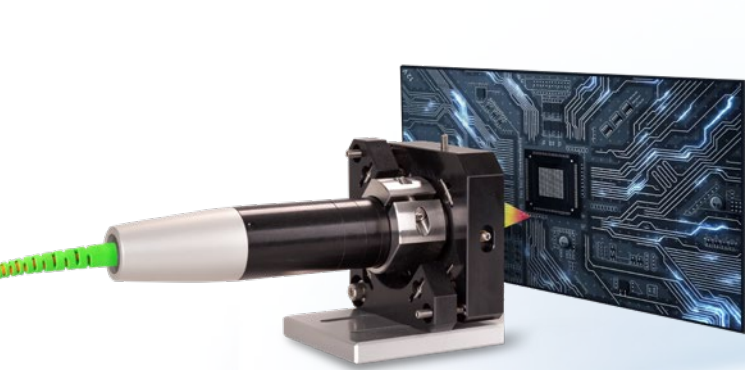

JMA-xx mounting adapter for distance measurements

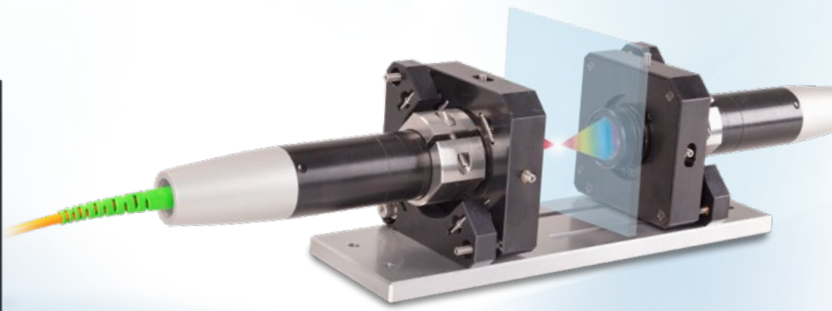

JMA-Thickness mounting adapter for two-sided thickness measurements

The adjustable JMA mounting adapter simplifies the alignment and fine adjustment of confocal sensors. The sensors are integrated and aligned directly in the machine together with the adapter. This corrects, e.g. minor deviations caused by mounting and compensates for tilted measuring objects. With two-sided thickness measurements, the JMA-Thickness mounting adapter supports the fine alignment of the two measuring points.

❶ Max. shift in X  $\pm 2$  mm



❷ Max. shift in Y  $\pm 2$  mm

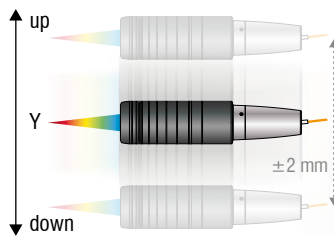

❸ Max. tilt angle in X  $\pm 4^\circ$



❹ Max. tilt angle in Y  $\pm 4^\circ$

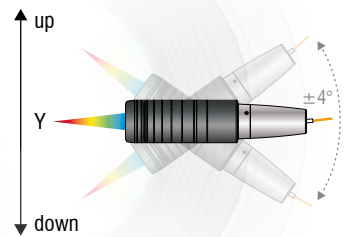

### Adjustable mounting adapter JMA

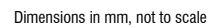

## Mounting adapter for individual sensors

Manual adjustment mechanism for easy and fast adjustment

Optimal sensor alignment for best possible measurement results

Ideally suitable for machine integration



Particularly for high resolution sensors with a small tilt angle, perpendicular installation is required. The JMA-xx mounting adapter enables fine alignment of the sensor to the target via the simple adjustment mechanism. This makes it easy to compensate for minor mounting deviations or tilted measuring objects.

### Scope of supply

- 1 JMA-xx
- 1 sensor holder for smaller diameters (not with JMA-27)
- 1 hexagon screwdriver for positioning
- Assembly instructions

| Model                        |   | JMA-08  | JMA-12   | JMA-20  | JMA-27  |
|------------------------------|---|---|--|---|---|
| Tilting range                | X | $\pm 4^\circ$ (continuously adjustable)                           |  |   |   |
|                              | Y | $\pm 4^\circ$ (continuously adjustable)                           |  |   |   |
| Shifting range               | X | $\pm 2$ mm (continuously adjustable)                              |  |   |   |
|                              | Y | $\pm 2$ mm (continuously adjustable)                              |  |   |   |
| Shock (DIN EN 60068-2-27)    |   | 15g / 6 ms in XYZ axis, 1000 shocks each                          |  |   |   |
| Vibration (DIN EN 60068-2-6) |   | 2g / 20 ... 500 Hz in XYZ axis, 10 cycles each                    |  |   |   |
| Adjustment mechanism         |   | Screw setting mechanism via M3x0.25 screw with hexagon socket 1.5 |  |   |   |
| Installation                 |   | 2x 2 mounting holes for M4x1                                      |  |   |   |
| Sensor mounting              |   | Radial clamping for $\varnothing 8$ mm                            | Radial clamping for $\varnothing 12$ mm                | Radial clamping for $\varnothing 20$ mm                       | Radial clamping for $\varnothing 27$ mm   |
| Compatibility                |   | confocalDT:<br>IFS2403 series                                     | confocalDT:<br>IFS2404-2<br>IFS2407-0,1<br>IFS2407-0,8 | confocalDT:<br>IFS2406-2,5/VAC<br>interferoMETER:<br>IMP-TH70 | confocalDT:<br>IFS2405-0,3<br>IFS2405-1<br>IFS2406-3<br>IFS2406-10<br>IFD2411-x |

### Application examples:

#### Alignment

Subsequent correction of the mounting position

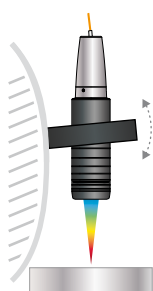

Compensates for incorrect target position

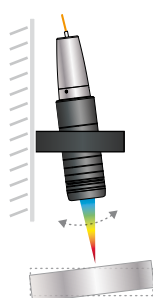

#### Positioning

Shifting the sensor to target area

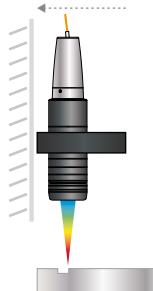

## Mounting adapter for two-sided thickness measurements

Optimal alignment of the optical axes enables high precision in two-sided thickness measurements

Pre-assembled for easy installation and fast commissioning

Ideally suitable for machine integration

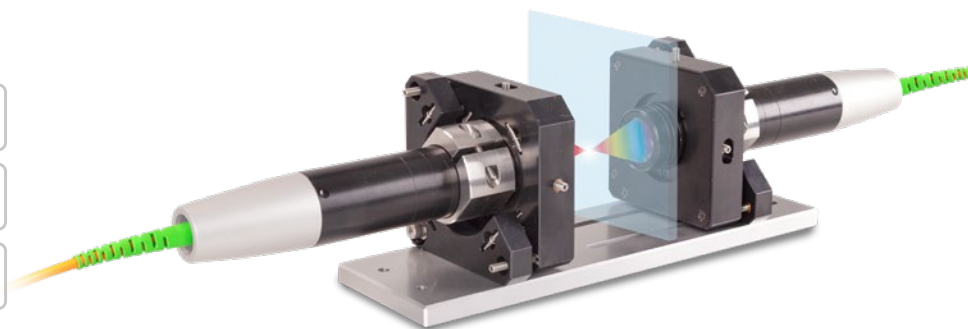

For two-sided thickness measurements, the JMA-Thickness mounting adapter supports the alignment of the measuring points to one another. This means that the measuring points are arranged absolutely congruent to each other so that the sensors are positioned exactly on an optical axis. This prevents measurements at an offset and a reliable measurement result is achieved with the highest possible precision.

When delivered, the two mounting adapters are pre-mounted on a mounting plate and aligned with one another. This simplifies installation and the measuring system can be put into operation more quickly. After installation into the machine, the plate can be removed, if necessary.

### Scope of supply

- 2 JMA-xx
- 1 JMP mounting plate
- 1 hexagon screwdriver 1.5 mm
- 1 Allen wrench 2.5 mm
- 1 Allen wrench 3.0 mm
- 1 Assembly instructions
- 2 optional reducing sleeves  
(depending on the package and the corresponding sensor)

| Model                        | JMA-Thickness | -08   | -12                                     | -20   | -27   |
|------------------------------|---------------|---|---|---|---|
| Shock (DIN EN 60068-2-27)    |               | 15g / 6 ms in XYZ axis, 1000 shocks each                          |   |   |   |
| Vibration (DIN EN 60068-2-6) |               | 2g / 20 ... 500 Hz in XYZ axis, 10 cycles each                    |   |   |   |
| Adjustment mechanism         |               | Screw setting mechanism via M3x0.25 screw with hexagon socket 1.5 |   |   |   |
| Sensor mounting              |               | Radial clamping<br>for ø 8 mm                                     | Radial clamping<br>for ø 12 mm          | Radial clamping<br>for ø 20 mm                                | Radial clamping<br>for ø 27 mm  |
| Compatibility                |               | confocalDT:<br>IFS2403 series                                     | confocalDT:<br>IFS2404-2<br>IFS2407-0,1 | confocalDT:<br>IFS2406-2,5/VAC<br>interferoMETER:<br>IMP-TH70 | confocalDT:<br>IFS2405-0,3<br>IFS2405-1<br>IFS2406-3<br>IFS2406-10<br>IFD2411-x |

### More precision with two-sided thickness measurements



**Without JMA-Thickness:**  
Measurement error with tilted target



**With JMA-Thickness:**  
Measures exactly at the opposite position

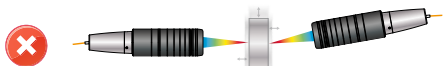

**Without JMA-Thickness:**  
Incorrect thickness measurement with vibrations

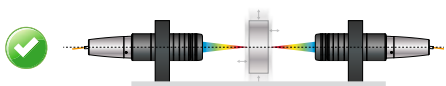

**With JMA-Thickness:**  
Sensors are on one optical axis –  
provides stability even with vibrating objects



**Without JMA-Thickness:**  
Sensors positioned incorrectly – no thickness measurement possible

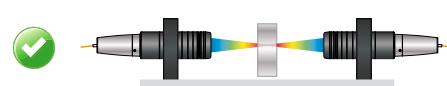

**With JMA-Thickness:**  
Optimal positioning support – object visible for both sensors

# Accessories

## Cables and connectors

### Software

IFD24xx-Tool      Software demo tool included

### Light source accessories

IFL2422/LED      Lamp module for IFC2422 and IFC2466

IFL24x1/LED      Lamp module for IFC2421 and IFC2465

### Optical fiber extension for sensors

CE2402 cable with 2x E2000/APC connectors

CE2402-x      Extension for optical fiber (3 m, 10 m, 13 m, 30 m, 50 m)

CE2402/PT3-x      Optical fiber extension with protection tube for mechanical stress  
(3 m, 10 m, customer-specific length up to 50 m)

### Optical fibers for IFS2404/IFS2404-2 and IFS2404/90-2 sensors

C2404-x      Optical fiber with FC/APC and E2000/APC connectors

Fiber core diameter 20  $\mu\text{m}$  (2 m)

### Optical fibers for IFS2405/IFS2406/2407-0,1/ IFS2407-3/IFD2411-x sensors

C2401 cable with FC/APC and E2000/APC connectors

C2401-x      Optical fiber (3 m, 5 m, 10 m, customer-specific length up to 50 m)

C2401/PT3-x      Optical fiber with protection tube for mechanical stress  
(3 m, 5 m, 10 m, customer-specific length up to 50 m)

C2401-x(01)      Optical fiber core diameter 26  $\mu\text{m}$  (3 m, 5 m, 15 m)

C2401-x(10)      Drag-chain suitable optical fiber (3 m, 5 m, 10 m)

C2400 cable with 2x FC/APC connectors

C2400-x      Optical fiber (3 m, 5 m, 10 m, customer-specific length up to 50 m)

C2400/PT-x      Optical fiber with protection tube for mechanical stress  
(3 m, 5 m, 10 m, customer-specific length up to 50 m)

C2400/PT-x-Vac      Optical fiber with protection tube suitable for use in vacuum  
(3 m, 5 m, 10 m, customer-specific length up to 50 m)

### Cables for IFD2410 /2415 sensors

PC2415-x      Supply/interface cable, drag-chain suitable,  
3 m, 6 m, 9 m, 15 m

PC2415-x/OE      Supply/interface cable open ends, drag-chain suitable,  
3 m, 6 m, 9 m, 15 m

PC2415-1/Y      Supply/interface cable Y, open ends and RJ45 plug,  
drag-chain suitable, 1 m

SC2415-x/OE      Multifunction cable, open ends, drag-chain suitable,  
3 m, 6 m, 9 m, 15 m

### Cables for IFD2411 sensors

SC2415-x/OE      Multifunction cable, open ends, drag-chain suitable, 3 m, 6 m, 9 m, 15 m

C2401-x      Optical fiber (3 m, 5 m, 10 m, customer-specific length up to 50 m)



Optical fiber C2401-x



Optical fiber with  
coating C2401/PT3-x



Drag-chain suitable  
optical fiber C2401-x(10)

## Optical fibers for IFS2407/90-0,3 sensors

C2407-x Optical fiber with DIN connector and E2000/APC (2 m, 5 m)

## Vacuum feedthrough

- C2402/Vac/KF16 Vacuum feedthrough with optical fiber, 1 channel, vacuum side FC/APC non-vacuum side E2000/APC, clamping flange KF 16
- C2405/Vac/1/KF16 Vacuum feedthrough on both sides FC/APC socket, 1 channel, clamping flange type KF 16
- C2405/Vac/1/CF16 Vacuum feedthrough on both sides FC/APC socket, 1 channel, flange type CF 16
- C2405/Vac/6/CF63 Vacuum feedthrough FC/APC socket, 6 channels, flange type CF 63

## Other accessories

- SC2471-x/USB/IND Connector cable IFC2461/71, 3 m, 10 m, 20 m
- SC2471-x/IF2008 Connector cable IFC2461/71-IF2008, 3 m, 10 m, 20 m
- PS2020 Power supply 24V / 2.5A
- EC2471-3/OE Encoder cable, 3m
- IF2030/PNET Interface module for PROFINET connection
- IF2030/ENETIP Interface module for EtherNet/IP connection

## Optical fiber

Temperature range : -50 °C to 90 °C

Bending radius: 30/40 mm

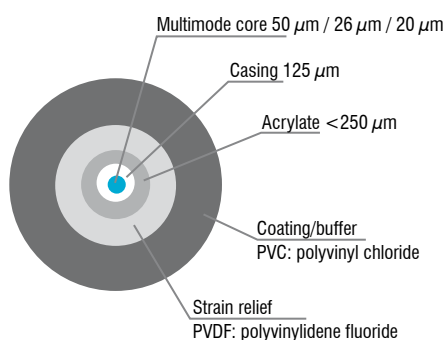

## E2000/APC standard connector

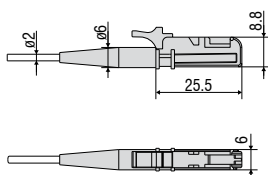

## FC/APC standard connector

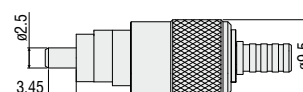

## DIN connector

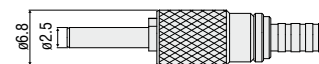

## Accessories

### Interface modules

| Module   | IFD2410 | IFD2411 | IFD2415 | IFC242x | IFC246x |
|--|---------|---------|---------|---------|---------|
| <b>IF2001/USB</b><br>Single-channel RS422/USB converter cable                                  | ✓       | ✓       | ✓       | ✓       | ✓       |
| <b>IF2004/USB</b><br>RS422/USB converter to convert up to 4 digital signals to USB             | ⊘       | ✓       | ⊘       | ✓       | ✓       |
| <b>IF2008/ETH</b><br>Interface module for Ethernet connection for up to 8 sensors              | ⊘       | ⊘       | ⊘       | ✓       | ✓       |
| <b>IF2008PCIE</b><br>Interface card for multiple sensor signals; analog and digital interfaces | ⊘       | ✓       | ⊘       | ✓       | ✓       |
| <b>IF2035/PNET</b><br>Interface module for Industrial Ethernet connection (PROFINET)           | ⊘       | ⊘       | ⊘       | ✓       | ✓       |
| <b>IF2035/ENETIP</b><br>Interface module for Industrial Ethernet connection (EtherNet/IP)      | ⊘       | ⊘       | ⊘       | ✓       | ✓       |

#### IF2001/USB converter RS422 to USB

The RS422/USB converter converts the digital signals of a confocal controller into a USB data packet. The sensor and the converter are connected via the RS422 interface of the converter. Data output is done via USB interface. The converter loops through further signals and functions such as laser on/off, switch signals and function output. The connected controllers and the converter can be programmed through software.

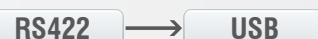

#### Special features

- Robust aluminum housing
- Easy sensor connection via screw terminals (plug and play)
- Conversion from RS422 to USB
- Supports baud rates from 9.6 kBaud to 12 MBaud

#### IF2004/USB: 4-channel converter from RS422 to USB

The RS422/USB converter is used for transforming digital signals of up to four confocal controllers into USB data signals. The converter has four trigger inputs and a trigger output for connecting additional converters. Data is output via an USB interface. The connected controllers and the converter can be programmed through software. The COM interfaces can be used individually and can be switched.



#### Special features

- 4x digital signals via RS422
- 4x trigger inputs, 1x trigger output
- Synchronous data acquisition
- Data output via USB

## IF2008/ETH

### IF2008/ETH Interface module for Ethernet connection with up to 8 sensors

The IF2008/ETH integrates up to eight sensors and/or encoders with an RS422 interface into an Ethernet network. Four programmable switching in-/outputs (TTL and HTL logic) are available.

10 indicator LEDs directly on the module show both the channel and the device status. In addition, acquisition and output of data via Ethernet is in addition performed at high speeds up to 200 kHz. Parameter setting of the interface module can be easily done via the web interface.



## IF2008PCle/IF2008E

### Interface card for synchronous data acquisition

Absolute synchronous data acquisition is a decisive factor for the deflection or straightness measurement using several controllers. The IF2008PCle interface card is designed for installation in PCs and enables the synchronous acquisition of four digital sensor signals and two encoders. The data is stored in a FIFO memory in order to enable resource-saving processing in blocks in the PC. The IF2008E expansion board enables to detect in addition two digital controller signals, two analog controller signals and eight I/O signals.

#### Special features

- IF2008PCle - Basic printed circuit board: 4 digital signals and 2 encoders
- IF2008E - Expansion board: 2x digital signals, 2x analog signals and 8x I/O signals

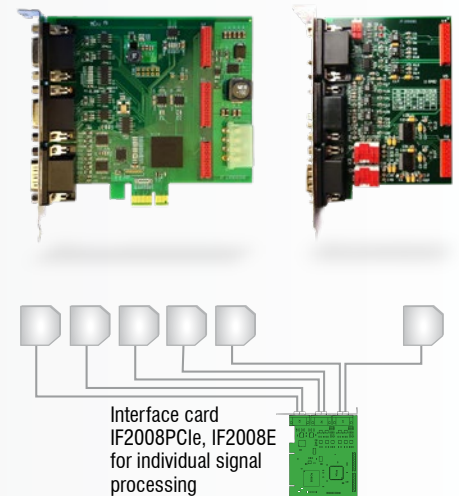

## IF2035

### Interface module for Industrial Ethernet connection

The IF2035 interface modules are designed for easy connection of Micro-Epsilon sensors to Ethernet-based fieldbuses. The IF2035 is compatible with sensors that output data via an RS422 or RS485 interface and supports the common Industrial Ethernet protocols EtherCAT, PROFINET and EtherNet/IP.

These modules operate on the sensor side with up to 4 MBd and have two network connections for different network topologies. In addition, the IF2035-EtherCAT offers a 4-fold oversampling function, which enables faster measurements than the bus cycle allows, if required. Installation in control cabinets is via a DIN rail.



## Sensors and Systems from Micro-Epsilon



Sensors and systems for displacement, distance and position



Sensors and measurement devices for non-contact temperature measurement

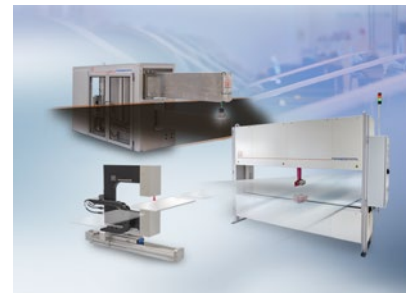

Measuring and inspection systems for metal strips, plastics and rubber



Optical micrometers and fiber optics, measuring and test amplifiers

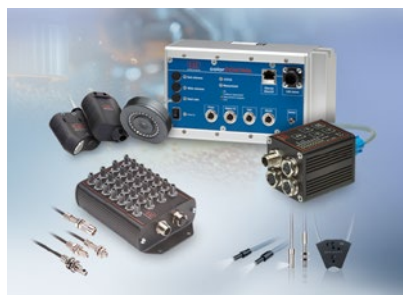

Color recognition sensors, LED analyzers and inline color spectrometers



3D measurement technology for dimensional testing and surface inspection